

STS II

Hand Based

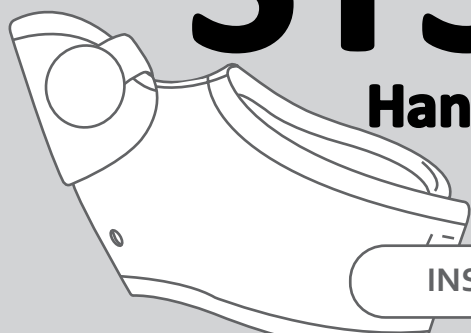

INSTRUCTIONS

SHORT THUMB SPICA II

antimicrobial treated



SHORT THUMB SPICA II - HAND BASED (STS II)
 FÉRULA EN ESPIGA CORTA PARA PULGAR BASADA EN LA MANO (STS II)
 EXOS™ DAUMENORTHESE KURZ II
 TUTORE CORTO PER POLLICE - MANO (SHORT THUMB SPICA II, STS II)
 ORTHÈSE DE POUCE (STS II) BASÉE SUR LA MAIN
 SPICA II KORTE DUIM - HANDBEUGEL (STS II)
 KRÁTKÁ ORTÉZA PALCA II - NA RUKU (STS II)
 SHORT THUMB SPICA II - TIL BRUG PÅ HÅNDEN (STS II)
 SHORT THUMB SPICA II - HANDBASERAD (STS II)
 LYHYT PEUKALOTUKI SPICA II, KÄMMENMALLI (STS II)
 KRÁTKÁ PALCOVÁ SPIKA II - NA RUKU (STS II)
 SHORT THUMB SPICA II (STS II) - SUPORTE NA MÃO
 SHORT THUMB SPICA II - HANDBASERT (STS II)
 SHORT THUMB SPICA II - 底部位于手掌 (STS II)
 SHORT THUMB SPICA II - 手 (STS II)



no. 10200 Rev D
 USA and International Patents Pending



Distributed by: DJO, LLC
 1430 Decision Street,
 Vista, CA 92081
 P 800.336.6569
 F 800.936.6569
 djoglobal.com

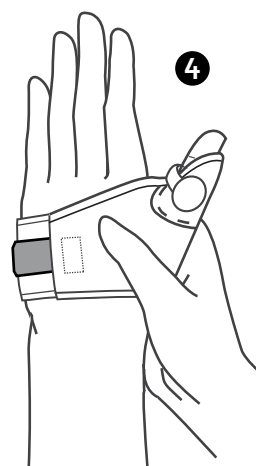
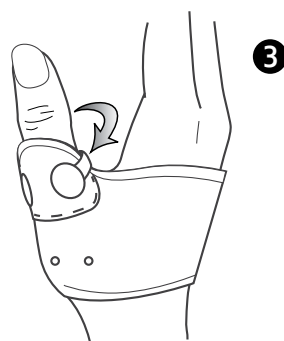
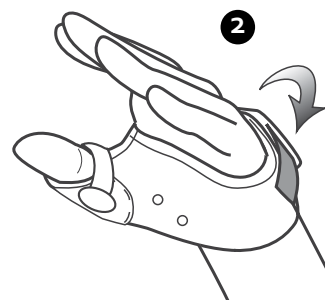
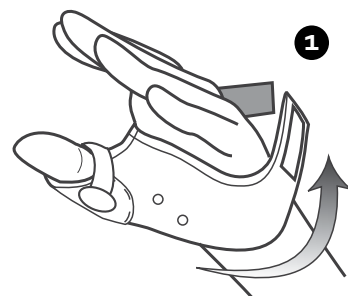

Before using the device, please read the entire instruction manual.
 Correct application and care is vital to the proper functioning of the device.

INTENDED USE / INDICATIONS

The Short Thumb Spica II (STS II) provides stabilization to the first metacarpophalangeal (MCP) joint and may be used preoperative, postoperative, post-traumatic as well as for degenerative conditions.

CONTRAINDICATIONS

Patients with known allergies to foams, adhesives, or plastic products.

⚠ WARNINGS and PRECAUTIONS

- ▶ Brace should be fitted by a qualified healthcare professional.
- ▶ Do not heat brace on the body.
- ▶ Check to make sure brace is not too hot prior to application.
- ▶ Brace should be appropriately sized to the patient to ensure proper support and function.
- ▶ Care should be taken with patients with delicate or compromised skin, especially the elderly, not to apply the brace too tightly, which MAY cause pressure and shear to the fragile tissue. PATIENTS SHOULD BE INSTRUCTED ON APPROPRIATE TENSIONING DURING ONGOING USE. An under sleeve or STOCKINETTE may be used for added protection.
- ▶ Do not heat Exos™ products to greater than 212°F (100°C).
- ▶ FOR SINGLE PATIENT USE ONLY.

HEATING AND APPLICATION

- ▶ Proper heating temperature is 200°F (93°C).
- ▶ Heat brace in Exos™ oven approximately 3 minutes or until brace is pliable. Brace should not be too hot to handle comfortably.
- ▶ Ensure that skin is completely dry before application.
- ▶ Fit brace on patient. (Figure 1)
- ▶ Secure hook closure on dorsal side of hand. (Figure 2)
- ▶ Secure the accessory strap in the desired position. (Figure 3)
- ▶ Mold brace into desired position. (Figure 4)

Warning: The brace should not be worn too tightly. This may produce excessive mechanical force or shear forces to the skin.

CLEANING INSTRUCTIONS

1. Loosen or remove the brace.
2. Wash inside and outside of brace and skin with antibacterial soap and water (86°F / 30°C).
3. Rinse thoroughly with water.
4. Use a hair dryer set on high volume and cool setting to thoroughly dry the interior of the brace, and skin.
5. Retighten the brace.



For fitting tips on each Exos™ device:
 Visit the Exos™ Provider Center at:
<http://exosmedical.com/provider/STSII> or
 Scan the QR image with your smartphone

MATERIAL USED

EVA foam, spandex, nylon, terpolymer, polyester
 Antimicrobial treatment

LIMITED PRODUCT WARRANTY

Exos™ covers defects in workmanship and materials up to 8 weeks from date this product is dispensed. Damage caused by normal wear and tear, abuse, or alterations is not covered.

To the extent the terms of this warranty are inconsistent with local regulations, the provisions of such local regulations will apply.



Exos LLC
 1122 Red Fox Road
 Arden Hills, MN 55112



Medical Device & QA Services Ltd
 76, Stockport Road, Timperley,
 Cheshire, WA15 7SN. United Kingdom
 Tel +44 161 870 6751 Fax +44 161 903 9787
 Email: info@mdqaservices.com
 www.mdqaservices.com